

Support SR0003H

Use and installation manual

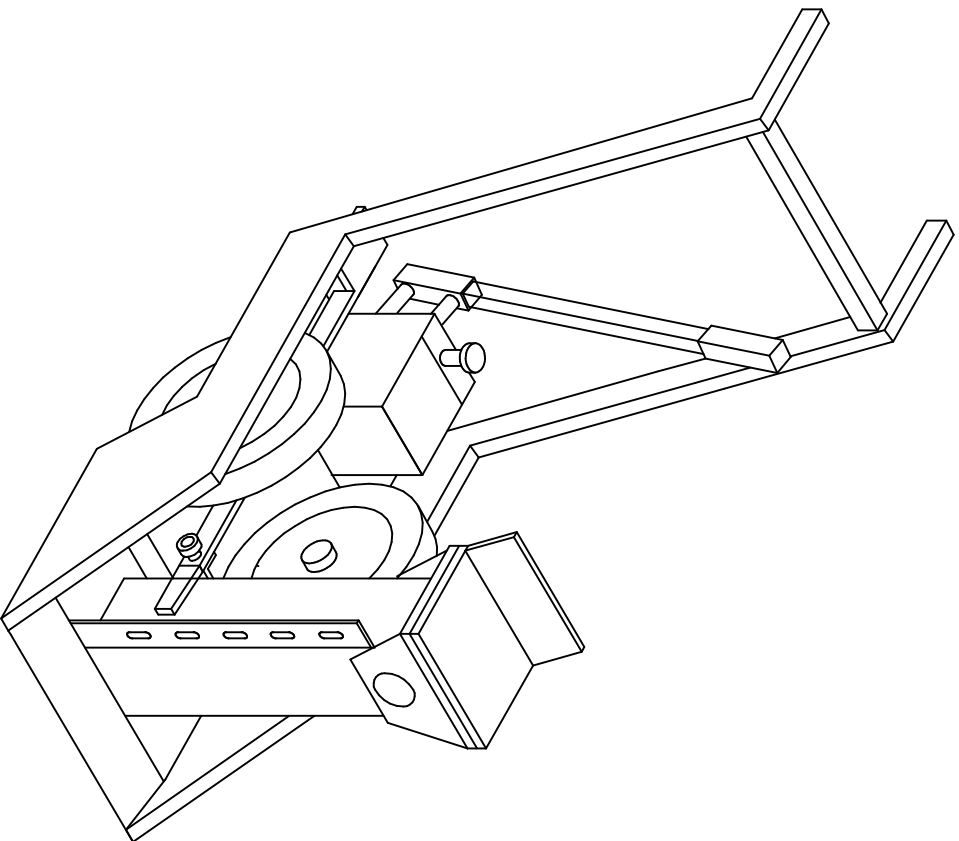

REAR SUPPORT FOR SEMITRAILER

SR0003H

SR0003H is designed to support on the rear part the semitrailer during the load - and unload operation by fork-lift.

According to safety regulations, prevent the kipping of semitrailer. Before starting any operation with SR0003H, read carefully this manual and use individual protection devices (workshoes, gloves, glasses and helmet).

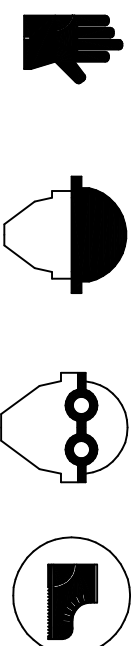

Only authorized people can operate/use SR0003H.

Remember to observe all safety steps regarding the semitrailer.

Maintenance and control operation have to be done only by repair shops. When SR0003H is in use/maintenance non-authorized people have to be kept on distance.

It is forbidden any other use which is not written on this manual. FERMI does not feel responsible for mishaps, breaking, accidents when the indications, here written, have not been applied.

This instruction manual has always to be easily at hand to the driver/operator at all times and has to be read before using SR0003H.

Before using SR0003H make sure that:

- The landing legs of semitrailer are in good conditions
- The ground where you operate is a firm and level surface
- The load on semitrailer is stable
- SR0003H is perpendicular to support surface of semitrailer
- During loading and unloading operation SR0003H does not go through direct or indirect shocks, wich could damage it.

Danger Zone

As danger zone it means all the whole area next the semitrailer, only the operator can work in this area. During the coupling and the uncoupling manoeuvres of the semitrailer, nobody has to be on the semitrailer or below it.

STATIC LOAD	4000 KG
WEIGHT	75 kg

SR0003H

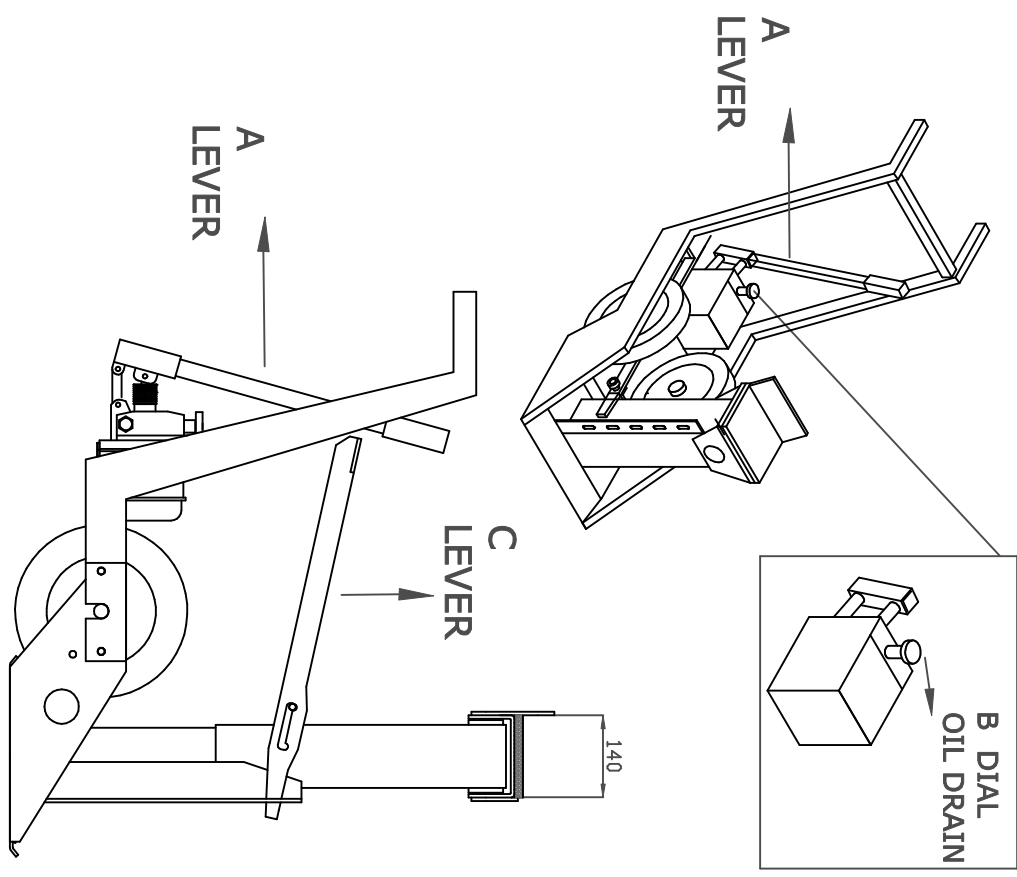
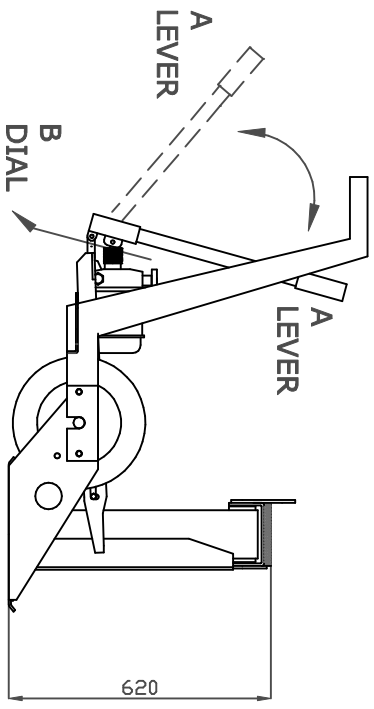
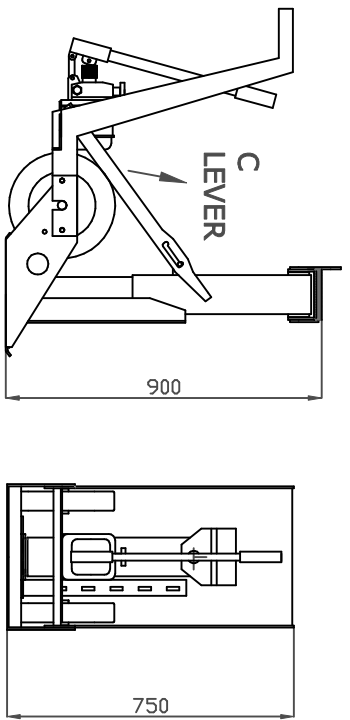

Attention: Grip A lever as below

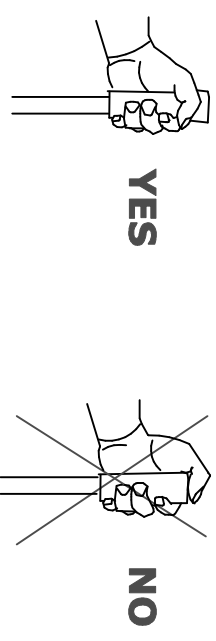

USE OF SUPPORT SR0003H

Before going on with any operation, make sure that the semitrailer is stationary and braked, following the instruction regarding the use of landing legs.
LANDING LEGS HAVE ALWAYS TO BE INSTALLED

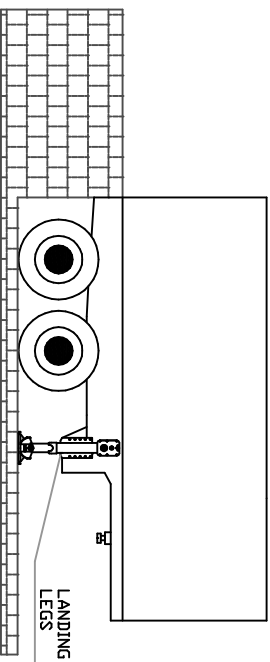

- Put SR0003H on lower position and insert it under the semitrailer.
Make sure the C lever is not inserted on holes and that B dial is closed.

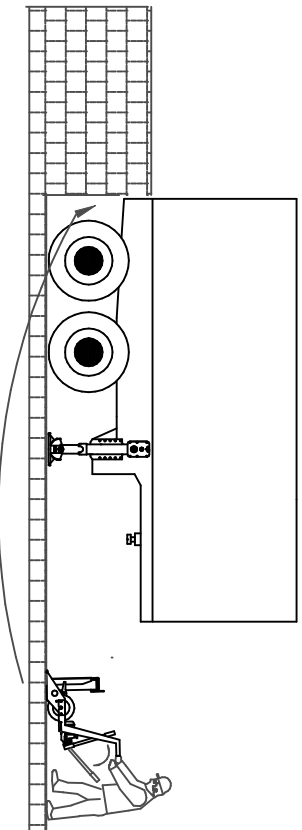

- Move A lever backward and forward until SR0003H touches the semitrailer.

TO REMOVE SR0003H:

- open B dial turning it on anti-clockwise
- insert C lever on the special holes (hole by hole) and in the meantime lower it by foot

How to positioning SR0003H

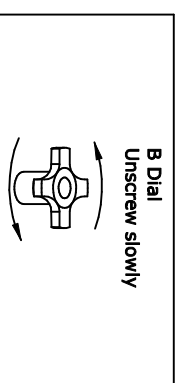
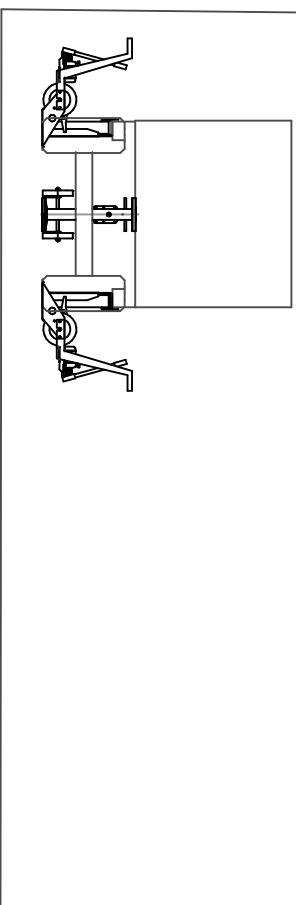
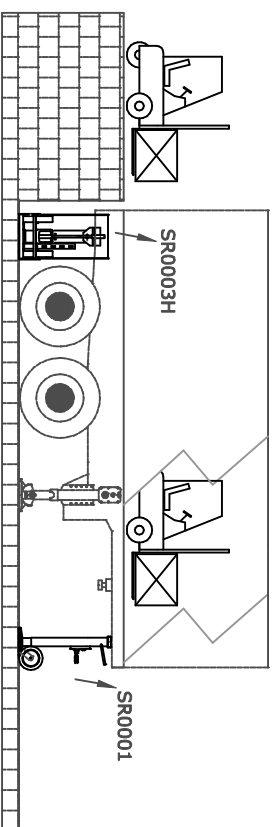

GUARANTEE

SR0003H has a 2 year guarantee wich falls into decline:
 If SR0003H has not been used as it is written on this manual
 If SR0003H has been tampered or modified.

MAINTENANCE

At the time of construction, the Fermi support SR0003H is greased and oiled enough. However, it is possible to make further greasing through the provided nipples. It is recommendable to do this operation every 6/8 months. For a better greasing of the spindle (through the greasing nipples situated on the sides of the support's body) lower completely the spindle and, while greasing it, lift it slowly up again.

It is advisable to use a grease with a EP 2-slowgigishness degree.
 Remember also to check periodically all the parts subject to wear, such as the nylon bushes, the gears and in particular the spindle and the female thread.

All this if the support SR0003H is used on normal working conditions. In case the support SR0003H is used in heavy conditions, these inspections have to be more frequent.

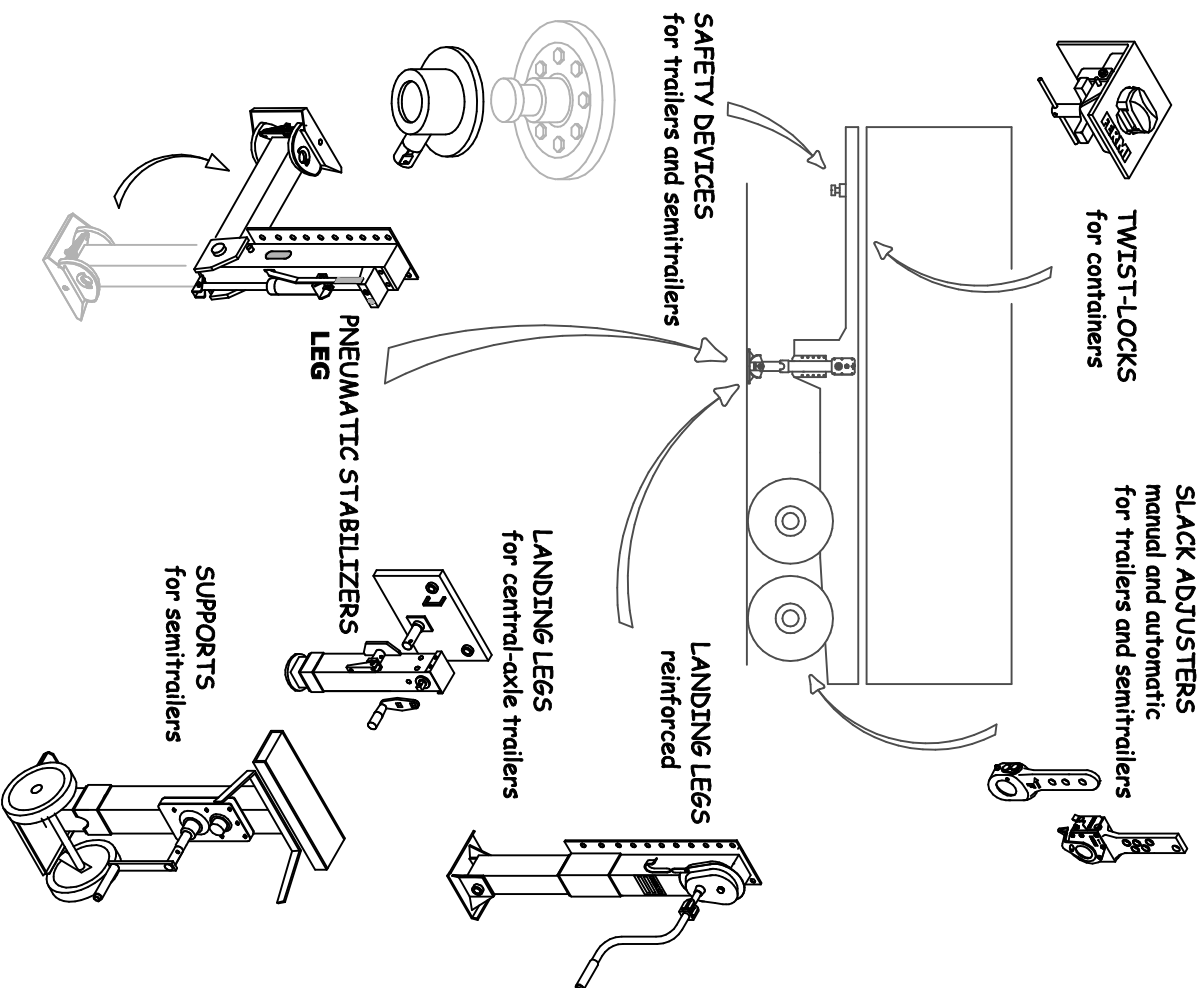

FERMI SRL

Via Postumia 33/A - 31100 Treviso (ITALY)
 Tel. +39(0)422-361033 Fax +39(0)422-361461
 www.fermitreviso.com info@fermitreviso.com